

The **INVALCO Model CQ-401** offers dual purpose action to automatically discharge vapor or liquid from a tank. The continuous drain valve is widely used in the bottom of fuel gas scrubbers to provide continuous drainage of the accumulated liquids and thus prevent transfer of the liquid to the burner section.

### Installations

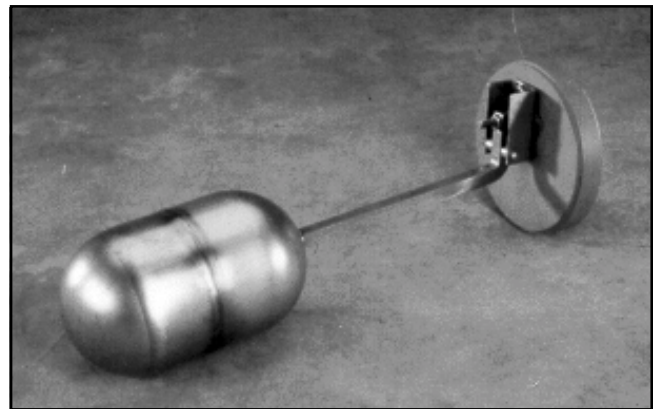
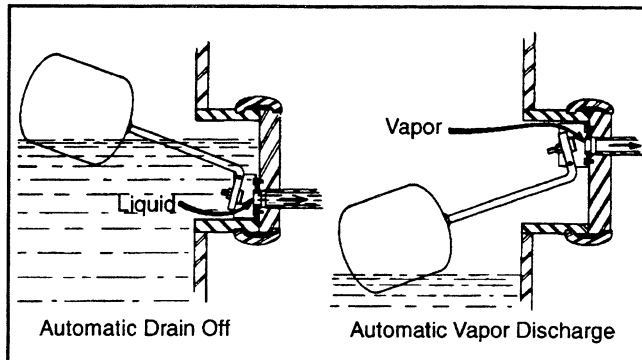

CQ-401 Continuous Drain Float

### Operation

With the drain valve installed in the position shown in the photo and the liquid level below the float, the vessel will be vented through 1/2" NPT port in the coupling adapter. Should the level rise above the float, the port will close preventing discharge of the liquid.

By rotating the entire assembly 180° the action will be reversed, allowing the port to open only when the liquid rises above the float. This arrangement is ideal for automatic drain-off.

### Standard Specifications

#### Float

3-1/2" x 6" long 316 S.S. ball-type.

#### Orifice

1/4", 1/8", 3/16", and 3/8" available.

#### Float Rod

5-1/2" long furnished as standard. 14-1/2" long available.

#### Mounting Connector

4" grooved coupling adapter

#### Flapper

Molded Buna-N

### Ordering Information

Catalog Model No.	Nozzle Pipe Size	Orifice Size	Part Number	Approx. Shipping Weight
CQ-401-820	4"	1/8"	80003102	5 lb
CQ-401-820	4"	3/16"	80003103	5 lb
CQ-401-820	4"	1/4"	80003105	5 lb
CQ-401-820	4"	3/8"	80003106	5 lb

**To Order:** Specify part number and catalog model number.

\*List prices do not include grooved coupling, clamps or nozzle.

### Dimensions

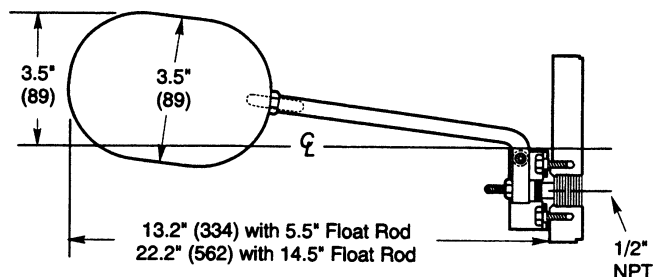

**Note:** Dimensions -- Inches to the nearest tenth (millimeters to the nearest whole mm), each independently dimensioned from respective engineering drawings.

# Parts

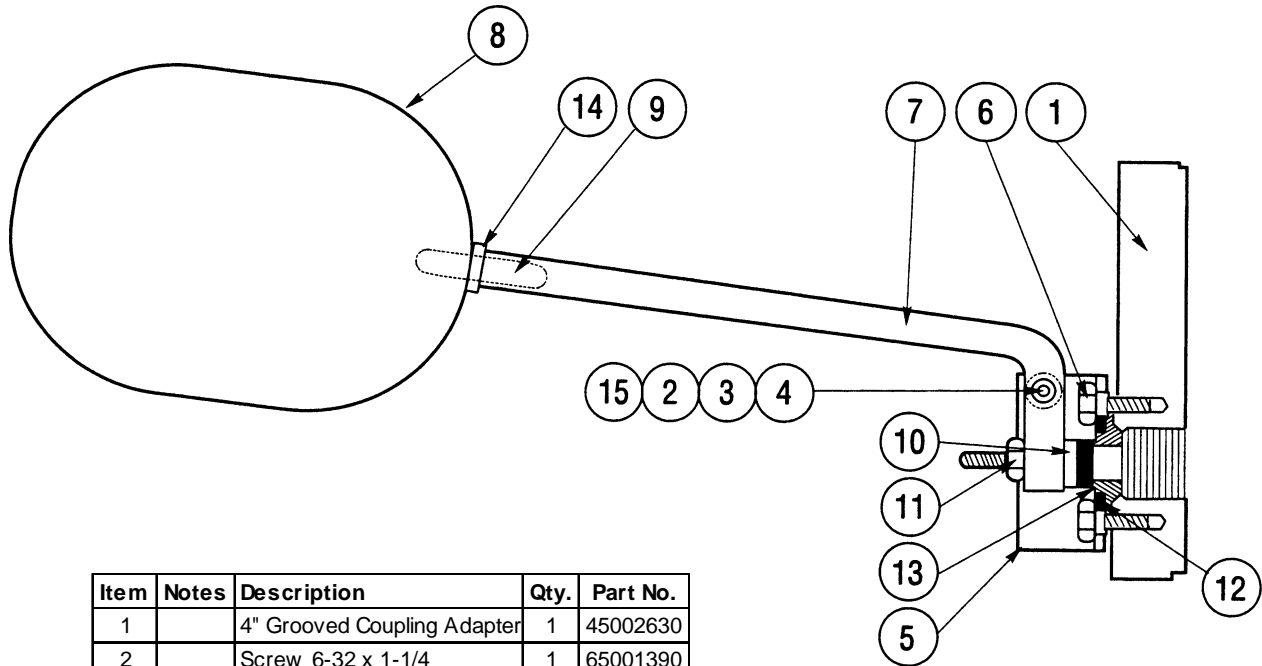

Item	Notes	Description	Qty.	Part No.
1		4" Grooved Coupling Adapter	1	45002630
2		Screw 6-32 x 1-1/4	1	65001390
3		Nut 6-32 Hex	2	65011435
4		Bushing	2	45002631
5		Orifice Retainer	1	45002632
6		Screw 1/4-20 x 1/2 HHCS	2	65006602
7		Float Rod-5-1/2" (Std.)	1	45002629
		Float Rod-14-1/2" (Spec.)	1	45003152
8	*	Float Ball, 3-1/2 x 6 316 SS	1	45005655
9		Screw 1/4-20 x 3/4 SHSS	1	65006033
10		Flapper	1	45001941
11		Nut 10-24 Hex	1	65008007
12	*	Orifice Gasket	1	45002628
13	*	Orifice 1/8"	1	45002493
		Orifice 3/16"	1	45002494
		Orifice 1/4"	1	45002495
		Orifice 3/8"	1	45002496
14		Washer 1/4 Lock	1	65006386
15		Washer #6 Tooth Lock	1	65007693

\*Recommended Spare Parts



[www.fmcinvalco.com](http://www.fmcinvalco.com)

The specifications contained herein are subject to change without notice and any user of said specifications should verify from the manufacturer that the specifications are currently in effect. Otherwise, the manufacturer assumes no responsibility for the use of specifications which may have been changed and are no longer in effect.

FMC INVALCO Fluid Control Stephenville, TX 76401, Phone: 254/968-2181, FAX: 254/968-5709, Toll Free: 800/468-2526  
 Printed in U.S.A. © 6/04 FMC INVALCO All rights reserved.